

VitrA

WC with BIDET FUNCTION

VitrA

VitrA

WC with BIDET FUNCTION



VitrA



VitrA

VitrA meets all your needs in your bathroom with its large product range including a wide variety of products from ceramics to furniture, bathing areas to tiles. VitrA is one of the few global brands that offer all products from A to Z in bathroom design and the design team preparing the collections of VitrA is cooperating with the most renowned designers in the world.

The designers VitrA has been cooperating with include Sir Terence Conran, Ross Lovegrove, Christophe Pillet, Matteo Thun, NOA Design Group, Pilots design, Inci Mutlu, Indeed, Nexus and Pentagon Design.

In line with the understanding on "Blue Life", adopted by its parent group, Turkish Eczacıbaşı Building Materials Group, VitrA attaches utmost importance to adoption and application of sustainability throughout all processes. This understanding is also shared by Engers Ceramics, Villeroy & Boch tiles and Burgbad, the Group's global players.

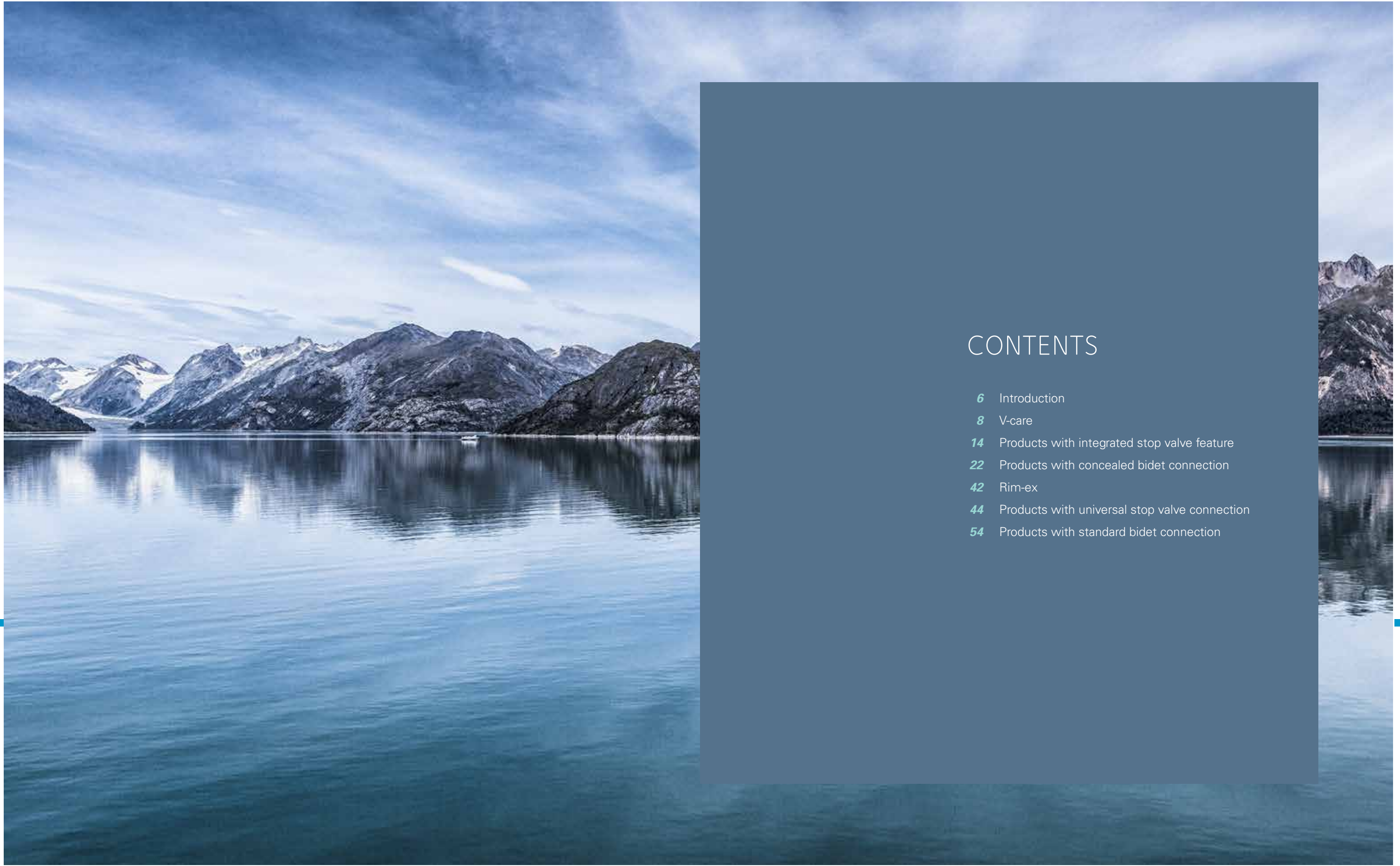

CONTENTS

- 6 Introduction
- 8 V-care
- 14 Products with integrated stop valve feature
- 22 Products with concealed bidet connection
- 42 Rim-ex
- 44 Products with universal stop valve connection
- 54 Products with standard bidet connection



Taking hygiene to a new level...

WC WITH BIDET FUNCTION

- » Compatible with all bathroom designs;
- » Contact-free cleanness
- » Saving space by using 2 products together
- » Innovative solution
- » Adjustable water temperature (for Premium series)

While bidet is used as a standard in Asian and Mediterranean countries, it is getting more commonly used in Europe, too. WCs with bidet feature provide deep hygiene and cleanness with water, combining the WC and bidet features in a single product.

We most commonly use water for cleanness in our daily lives. This innovative solution developed using bidet nozzle, adds post-toilet cleaning to the areas of use of water, which is an absolute must for hygiene in all areas, from hand wash to shower.

The need for hygiene gets even more important during times of health problems, women's menstrual cycles and at older ages. Bidet nozzle, which is mounted to WC almost invisibly and thus keeps your bathroom chic, provides a great ease for all users. In particular, it creates great comfort for the physically disabled individuals. In addition, what you only need for bidet nozzle is just one more cold water connection!

The most comfortable personal washing system

VitrA offers the most comfortable personal washing system for cleverly-designed healthcare projects. With its rimless Rim-ex technology, V-care washes hygienically and easily.

V-care is a very comfortable innovation by VitrA with its small WC pan automatic open/close, adjustable water and seat temperature, various washing options, dryer and deodorization. Besides, all these features can be adjusted via a remote control according to the personal needs of users.

V-care



V-care



Washing suitability for users with all its fine details



5-level adjustable seat temperature



5-level adjustable water temperature



Water strength adjustment with massage and pulsation washing. Nozzle tip position adjustment



Automatically-activating deodorization feature



5-level adjustable drying after washing



Automatic open/close sensor WC seat for hygienic use without hand touch



Comfort

- Lady & rear washing options
- Pulsating & oscillating washing options
- Water pressure & position adjustment
- Seat temperature adjustment
- Water temperature adjustment
- Dryer / dryer temperature adjustment
- Air purifier
- Automatic seat open-close



Basic

- Lady & rear washing options
- Water pressure & position adjustment
- Seat temperature adjustment
- Water temperature adjustment
- Air purifier



Basic

Rear and front washing options, adjustable bidet nozzle, water temperature control, WC seat with temperature control, removable-stainless steel-hygienic bidet nozzle, no-odor filter, soft close seat

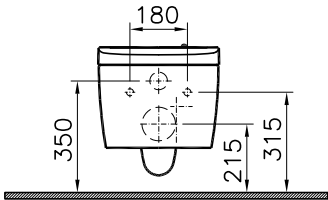
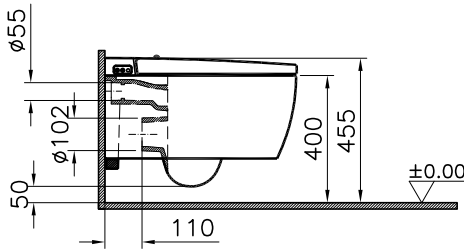
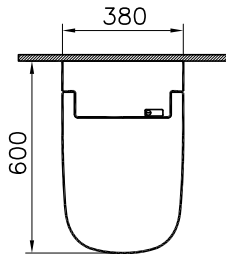

Additional pipe may be required as to wall thickness.

Product description	Code	W x H (mm)
V-care intelligent WC	5674B003-6103	380 x 600



Comfort

Rear and front washing options, adjustable bidet nozzle, water temperature control, WC seat with temperature control, removable-stainless steel-hygienic bidet nozzle, no-odor filter, soft close seat, automatic open-close, oscillating and pulsating washing options, adjustable drying function

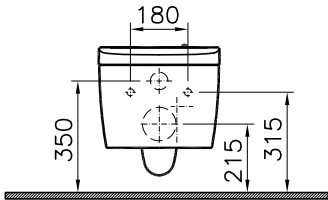
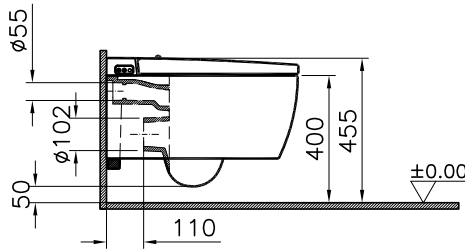
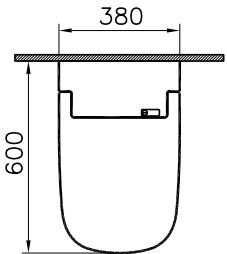

Additional pipe may be required as to wall thickness.

Product description	Code	W x H (mm)
V-care intelligent WC	5674B003-6104	380 x 600

Highest comfort for bathroom experience

VitrA offers alternatives providing ergonomic use and comfort for personal hygiene, with its WCs with bidet function. The integrated stop valve on the WC allows you to adjust the water temperature as you wish, by mixing hot and cold water. Thermostatic integrated stop valve fixes water temperature at maximum 38°C for best use.

PRODUCTS WITH INTEGRATED STOP VALVE FEATURE

- » METROPOLE
- » NEST



Metropole Rim-ex wall-hung WC pan

With bidet function, with thermostatic cartridge integrated stop valve (on left)

Thermostatic cartridge integrated stop valve (mixes hot and cold water for bidet function) For best user experience temprature of the water fixes at maximum 38 degrees. If you have heating system that work with gas (combi boiler, flash heater etc.), low flow rate of bidet water might prevent the system to heat and result in late arrival of hot water. It is advised to use thermostatic cartridge integrated stop valve if you have central or electrical heating system.

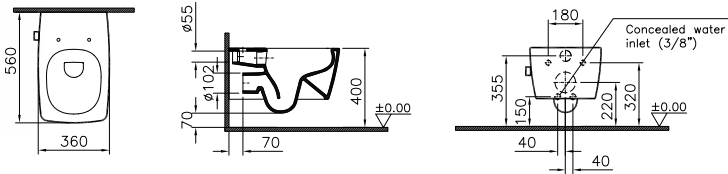

Additional pipe may be required as to wall thickness.

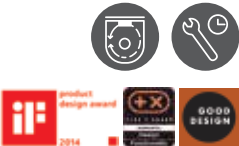

Product description	Code	W x H (mm)
Rim-ex wall-hung WC pan, 56 cm	7672B003-1584	360 x 560

Metropole Rim-ex wall-hung WC pan

With bidet function, with standard cartridge integrated stop valve (on left)

Standart cartridge integrated stop valve, (mixes hot and cold water for bidet function). For best user experience temprature of the water should be arranged via valve handle. To prevent dangerous surges of heat due to instant hot water, it is highly advised to process water while handle is in middle (mix) position. If you have heating system that work with gas (combi boiler, flash heater etc.), low flow rate of bidet water might prevent the system to heat and result in late arrival of hot water. It is advised to use thermostatic cartridge integrated stop valve if you have central or electrical heating system.

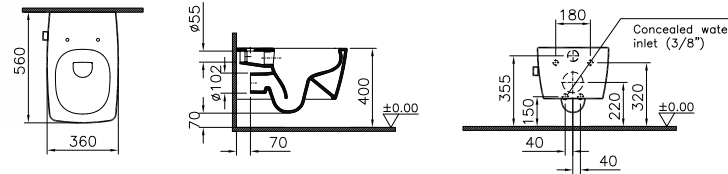

Additional pipe may be required as to wall thickness.



Product description	Code	W x H (mm)
Rim-ex wall-hung WC pan, 56 cm	7672B003-1084	360 x 560

Metropole Wall-hung WC pan

With bidet function, with thermostatic cartridge integrated stop valve (on left)

Thermostatic cartridge integrated stop valve (mixes hot and cold water for bidet function) For best user experience temprature of the water fixes at maximum 38 degrees. If you have heating system that work with gas (combi boiler, flash heater etc.), low flow rate of bidet water might prevent the system to heat and result in late arrival of hot water. It is advised to use thermostatic cartridge integrated stop valve if you have central or electrical heating system.

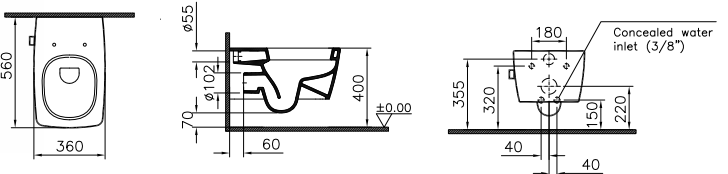

Additional pipe may be required as to wall thickness.

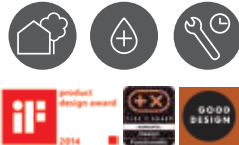

Product description	Code	W x H (mm)
Wall-hung WC pan, 56 cm	5676B003-1584	360 x 560

Metropole Wall-hung WC pan

With bidet function, with standard cartridge integrated stop valve (on left)

Standart cartridge integrated stop valve, (mixes hot and cold water for bidet function). For best user experience temprature of the water should be arranged via valve handle. To prevent dangerous surges of heat due to instant hot water, it is highly advised to process water while handle is in middle (mix) position. If you have heating system that work with gas (combi boiler, flash heater etc.), low flow rate of bidet water might prevent the system to heat and result in late arrival of hot water. It is advised to use thermostatic cartridge integrated stop valve if you have central or electrical heating system.

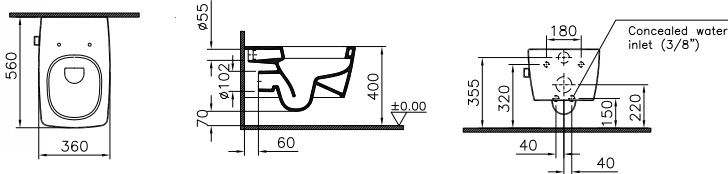

Additional pipe may be required as to wall thickness.



Product description	Code	W x H (mm)
Wall-hung WC pan, 56 cm	5676B003-1084	360 x 560

Nest Rim-ex wall-hung WC pan



With bidet function, with thermostatic cartridge integrated stop valve (on left)

Thermostatic cartridge integrated stop valve (mixes hot and cold water for bidet function) For best user experience temprature of the water fixes at maximum 38 degrees. If you have heating system that work with gas (combi boiler, flash heater etc.), low flow rate of bidet water might prevent the system to heat and result in late arrival of hot water. It is advised to use thermostatic cartridge integrated stop valve if you have central or electrical heating system.

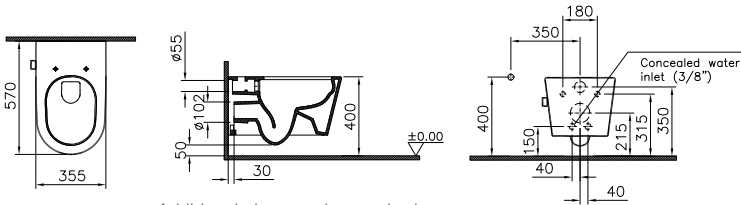

Additional pipe may be required as to wall thickness.

Product description	Code	W x H (mm)
Rim-ex wall-hung WC pan, 56 cm	5176B003-1584	355 x 570



Nest Rim-ex wall-hung WC pan



With bidet function, with standard cartridge integrated stop valve (on left)

Standart cartridge integrated stop valve, (mixes hot and cold water for bidet function). For best user experience temprature of the water should be arranged via valve handle. To prevent dangerous surges of heat due to instant hot water, it is highly advised to process water while handle is in middle (mix) position. If you have heating system that work with gas (combi boiler, flash heater etc.), low flow rate of bidet water might prevent the system to heat and result in late arrival of hot water. It is advised to use thermostatic cartridge integrated stop valve if you have central or electrical heating system.

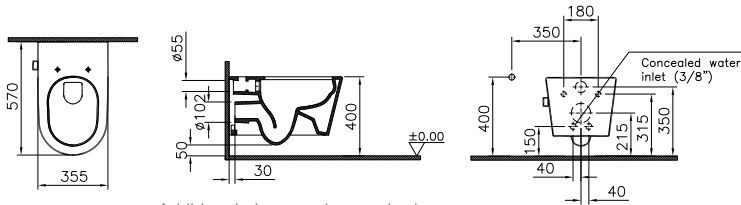

Additional pipe may be required as to wall thickness.

Product description	Code	W x H (mm)
Rim-ex wall-hung WC pan, 56 cm	5176B003-1084	355 x 570



Nest Wall-hung WC pan



With bidet function, with thermostatic cartridge integrated stop valve (on left)

Thermostatic cartridge integrated stop valve (mixes hot and cold water for bidet function) For best user experience temprature of the water fixes at maximum 38 degrees. If you have heating system that work with gas (combi boiler, flash heater etc.), low flow rate of bidet water might prevent the system to heat and result in late arrival of hot water. It is advised to use thermostatic cartridge integrated stop valve if you have central or electrical heating system.

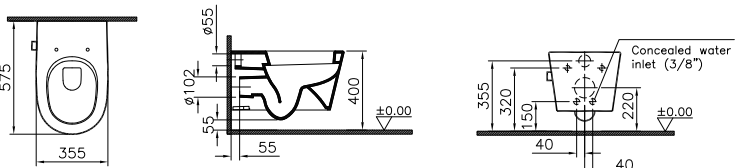

Additional pipe may be required as to wall thickness.

Product description	Code	W x H (mm)
Wall-hung WC pan, 57 cm	5173B003-1584	355 x 575



Nest Wall-hung WC pan



With bidet function, with standard cartridge integrated stop valve (on left)

Standart cartridge integrated stop valve, (mixes hot and cold water for bidet function). For best user experience temprature of the water should be arranged via valve handle. To prevent dangerous surges of heat due to instant hot water, it is highly advised to process water while handle is in middle (mix) position. If you have heating system that work with gas (combi boiler, flash heater etc.), low flow rate of bidet water might prevent the system to heat and result in late arrival of hot water. It is advised to use thermostatic cartridge integrated stop valve if you have central or electrical heating system.

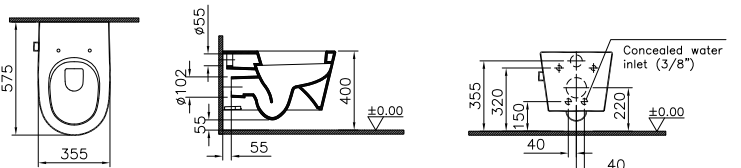

Additional pipe may be required as to wall thickness.

Product description	Code	W x H (mm)
Wall-hung WC pan, 57 cm	5173B003-1084	355 x 575



INSTALLATION OF
INTEGRATED STOP VALVE

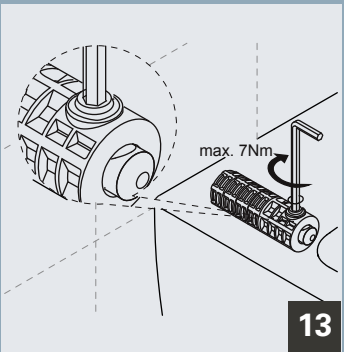
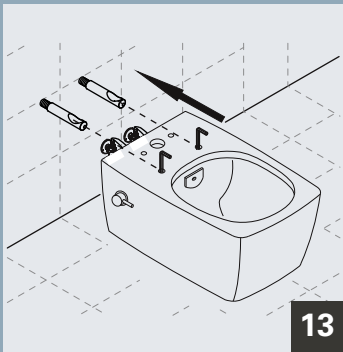
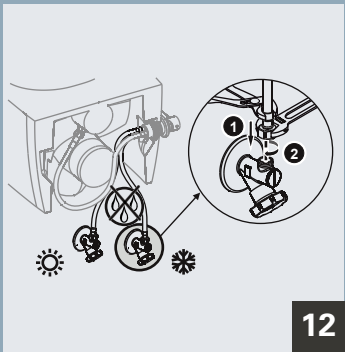
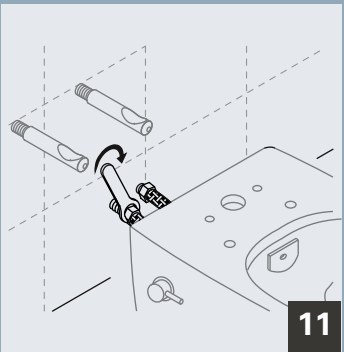
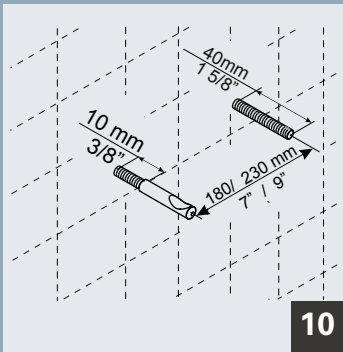
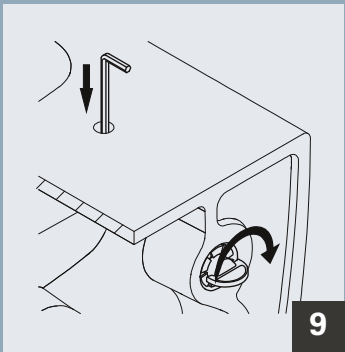
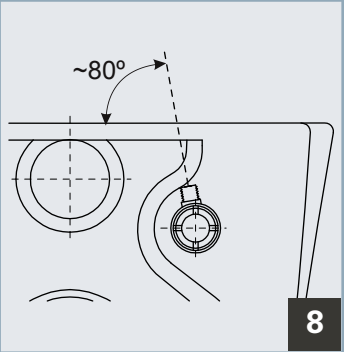
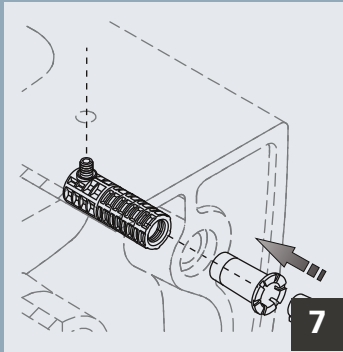
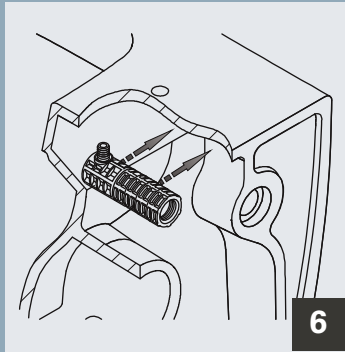
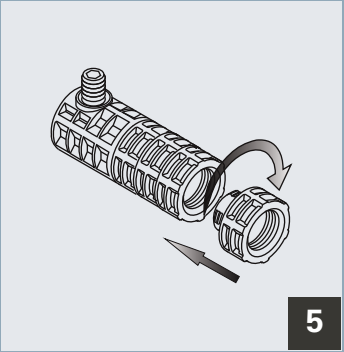
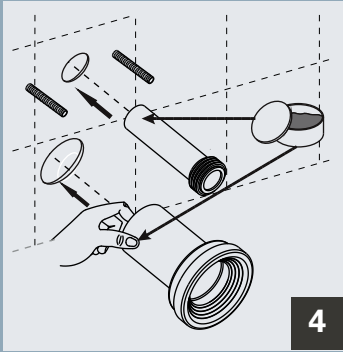
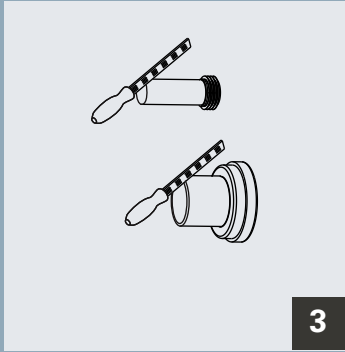
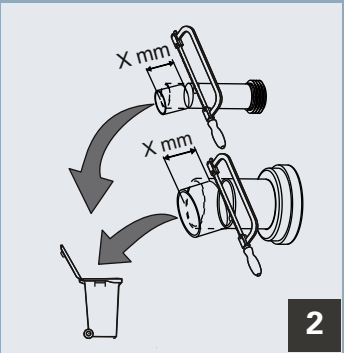
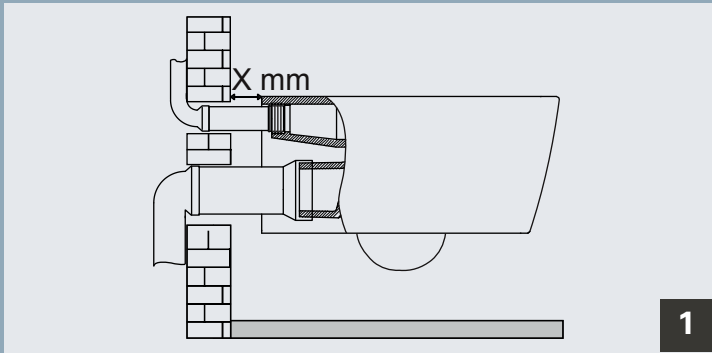
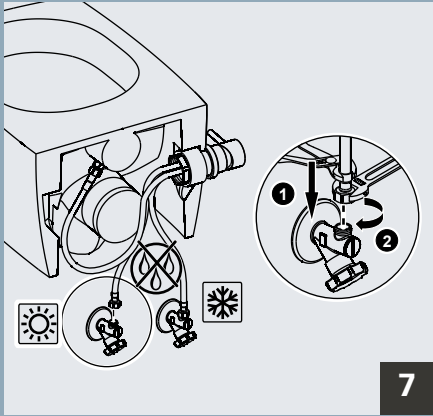
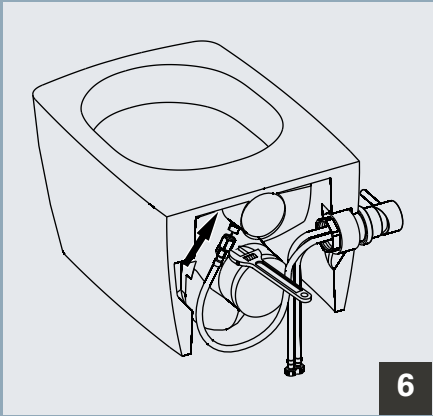
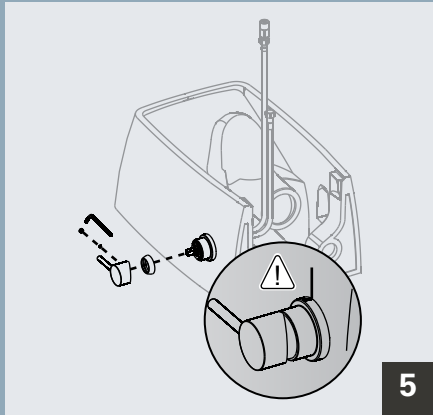
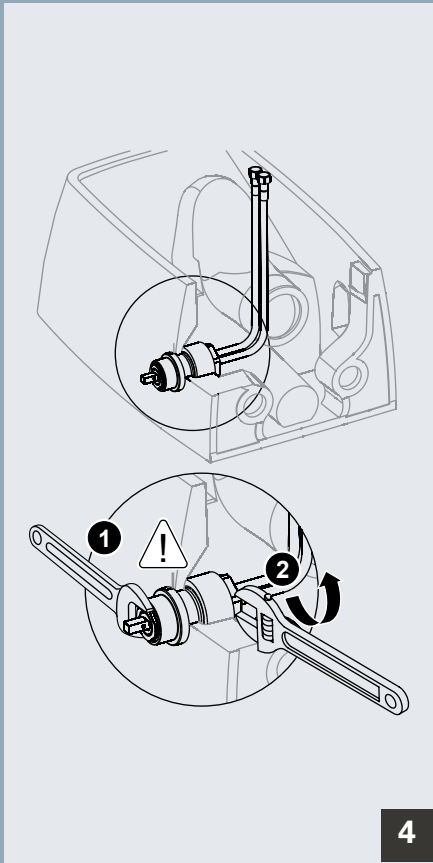
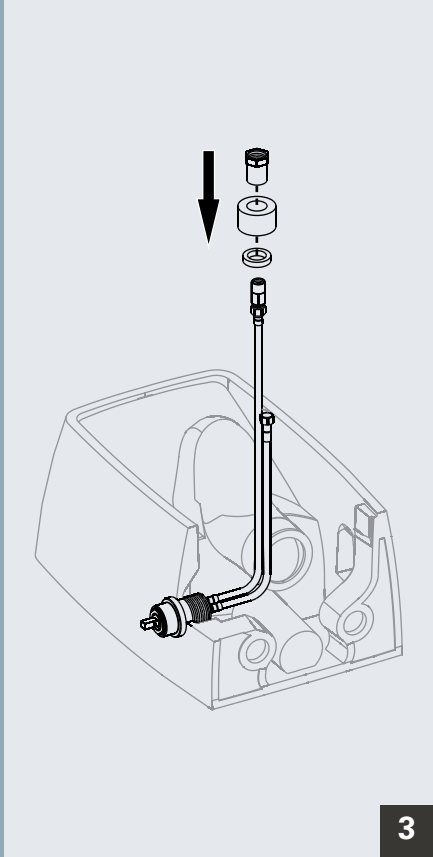
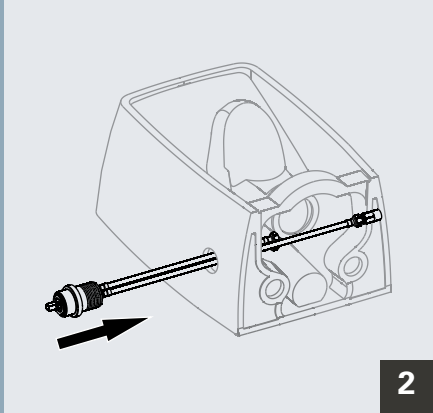
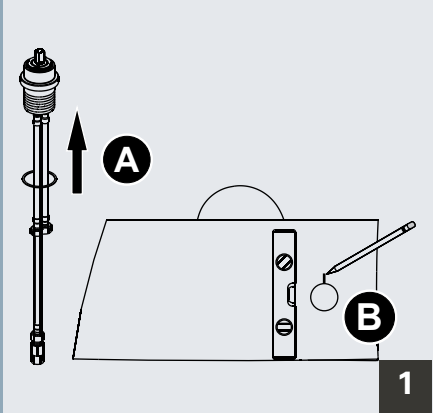

Sophisticated technology combined with comfort

VitrA combines advanced technology and WCs with bidet function, for the users who do not want to compromise on chicness in their bathroom. In the concealed bidet pipe application, the stop valve connection is embedded inside the wall with concealed connection parts, and the flexible hose connects to the product from the rear side. This helps you to preserve bathroom comfort while attaining a clean and neat appearance.

PRODUCTS WITH CONCEALED BIDET CONNECTION

- » MEMORIA
- » ISTANBUL
- » FRAME
- » ARIA
- » NEST
- » METROPOLE
- » BELLA
- » MONDO
- » SENTO
- » SHIFT
- » D-LIGHT
- » S50
- » RETRO
- » ZENTRUM
- » S20
- » ARKİTEKT



Memoria Rim-ex wall-hung WC pan

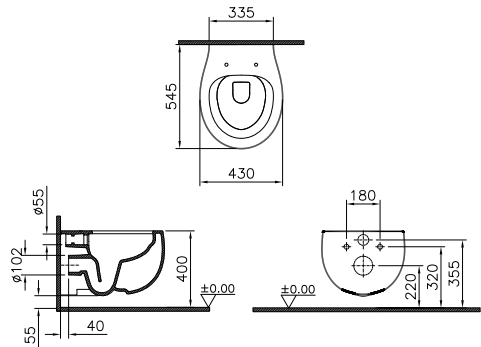

Additional pipe may be required as to wall thickness.

Product description	Code	W x H (mm)
Rim-ex wall-hung WC pan, 54 cm	5885B403-0090	430 x 545



Frame Rim-ex wall-hung WC pan

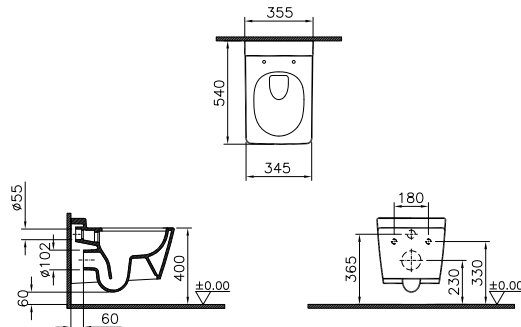

Additional pipe may be required as to wall thickness.

Product description	Code	W x H (mm)
Rim-ex wall-hung WC pan, 54 cm	7743B003-0090	345 x 540



Istanbul wall-hung WC pan

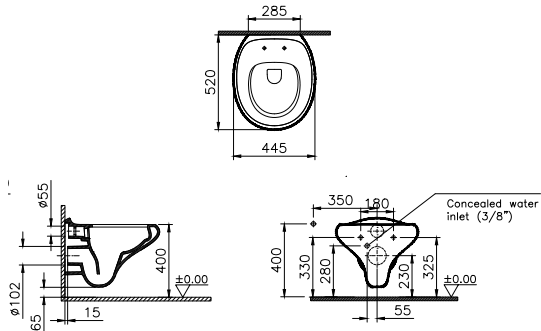

Product description	Code	W x H (mm)
Wall-hung WC pan, 52 cm	4518B403-0000	445 x 520
Discontinues by the 1st of September 2017		



Aria wall-hung WC pan

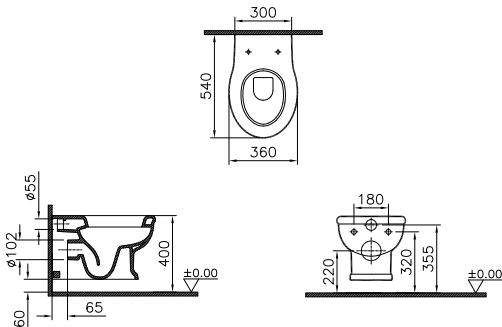

Additional pipe may be required as to wall thickness.

Product description	Code	W x H (mm)
Wall-hung WC pan, 54 cm	5802B003-0090	360 x 540



Nest single WC pan, back-to-wall

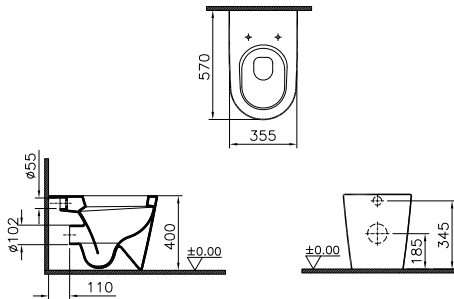

Product description	Code	W x H (mm)
Single WC pan, back-to-wall, 57 cm (Horizontal outlet)	5138B003-0090	355 x 570

Nest wall-hung WC pan

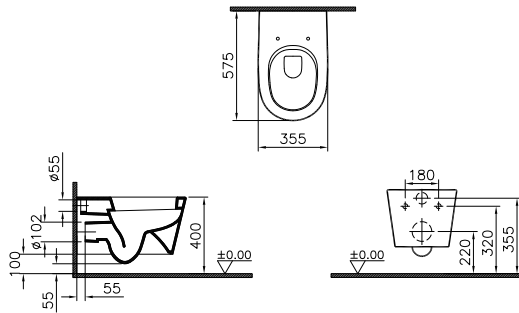

Additional pipe may be required as to wall thickness.

Product description	Code	W x H (mm)
Wall-hung WC pan, 57 cm	5173B003-0090	355 x 575



Nest Rim-ex wall-hung WC pan

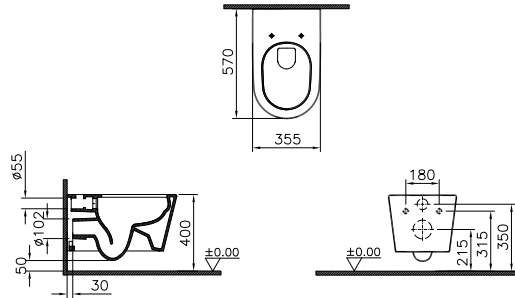

Additional pipe may be required as to wall thickness.

Product description	Code	W x H (mm)
Rim-ex wall-hung WC pan, 57 cm	5176B003-0090	355 x 570



Metropole single WC pan, back-to-wall

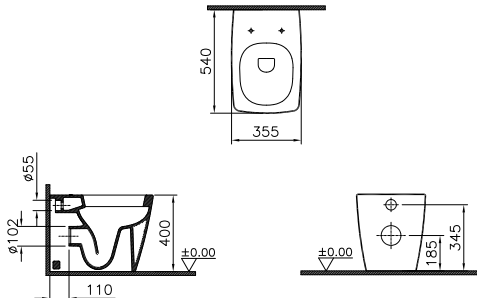

Product description	Code	W x H (mm)
Single WC pan, back-to-wall, 54 cm (Horizontal outlet)	5678B003-0090	355 x 540

Metropole close-coupled WC pan, back-to-wall

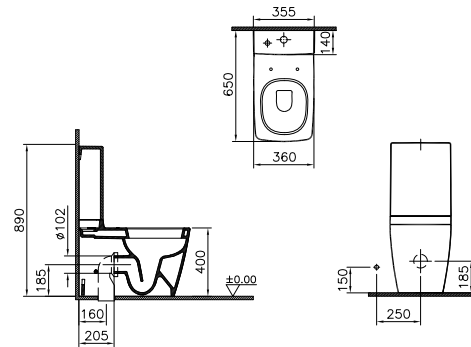

Product description	Code	W x H (mm)
Close-coupled WC pan, back-to-wall, 65 cm (Universal outlet)	5677B003-0610	360 x 650

Metropole wall-hung WC pan

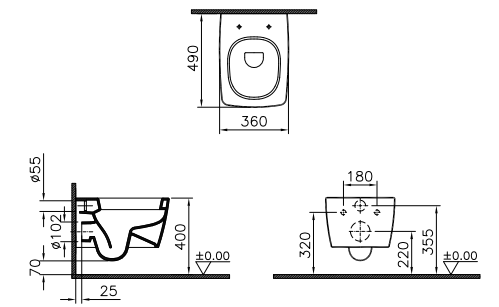

Product description	Code	W x H (mm)
Wall-hung WC pan, 48 cm, compact	5671B003-0090	360 x 490



Metropole Rim-ex wall-hung WC pan

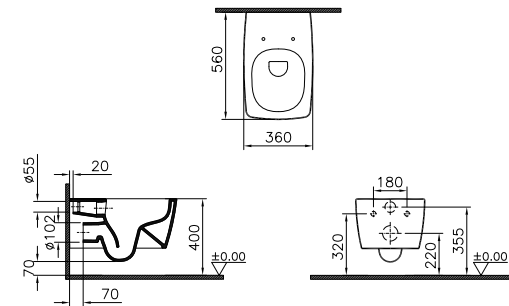

Additional pipe may be required as to wall thickness.

PRODUCT DESCRIPTION	CODE	W X H (MM)
Rim-ex wall-hung WC pan, 56 CM	7672B003-0090	360 X 560



Metropole wall-hung WC pan

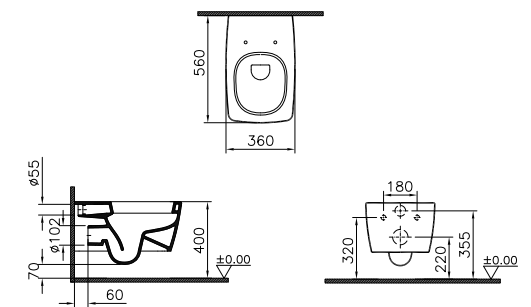

Additional pipe may be required as to wall thickness.

Product description	Code	W x H (mm)
Wall-hung WC pan, 56 cm	5676B003-0090	360 x 560

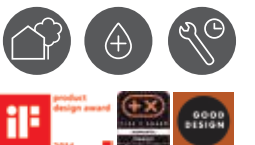

Bella wall-hung WC pan

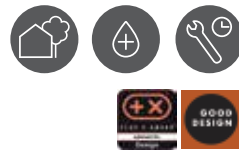
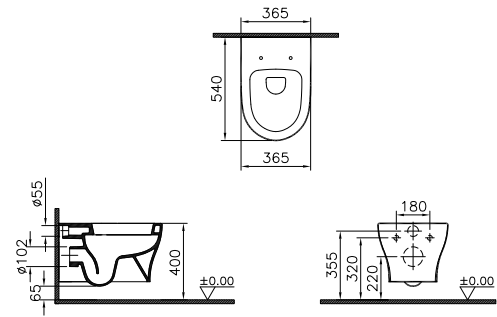

Product description	Code	W x H (mm)
Wall-hung WC pan	4449B003-0090	365 x 540

Mondo wall-hung WC pan

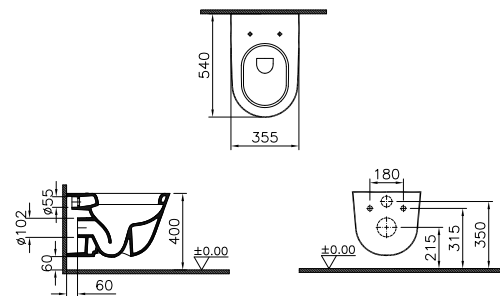

Additional pipe may be required as to wall thickness.



Product description	Code	W x H (mm)
Wall-hung WC pan	5693B003-0090	355 x 540

Sento Rim-ex wall-hung WC pan

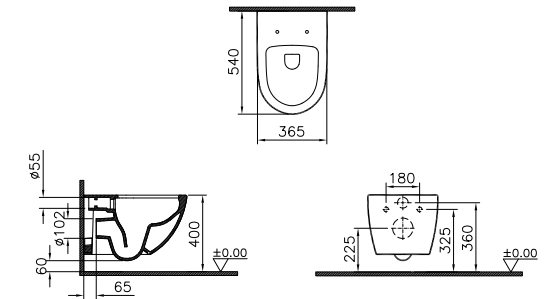

Additional pipe may be required as to wall thickness.



Product description	Code	W x H (mm)
Rim-ex wall-hung WC pan, 54 cm	7748B003-0090	365 x 540

Sento wall-hung WC pan

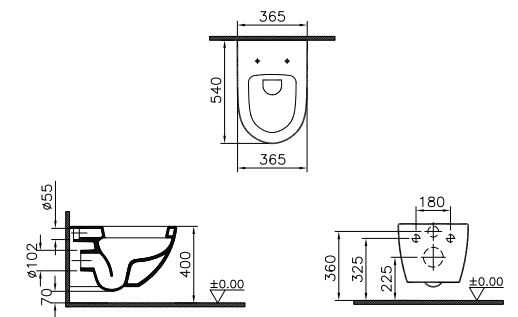

Product description	Code	W x H (mm)
Sento wall-hung WC pan, 54 cm	4448B003-0090	365 x 540

Sento wall-hung WC pan, compact

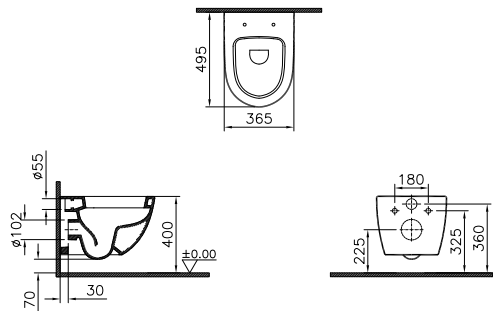

Product description	Code	W x H (mm)
Wall-hung WC pan, 50 cm, compact	4337B003-0090	365 x 495



Shift wall-hung WC pan

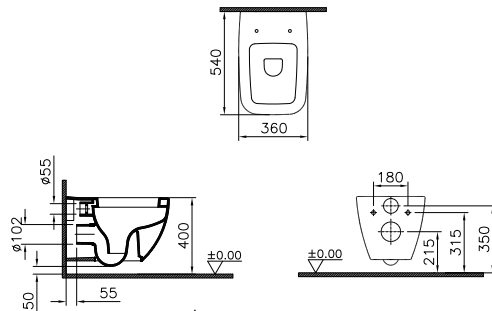

Additional pipe may be required as to wall thickness.

Product description	Code	W x H (mm)
Wall-hung WC pan, 54 cm	4392B003-1298	360 x 540



Shift Rim-ex wall-hung WC pan

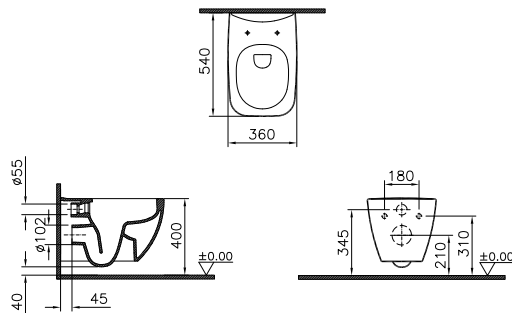

Additional pipe may be required as to wall thickness.

Product description	Code	W x H (mm)
Rim-ex wall-hung WC pan, 54 cm	7742B003-0090	360 x 540



Shift wall-hung WC pan, compact

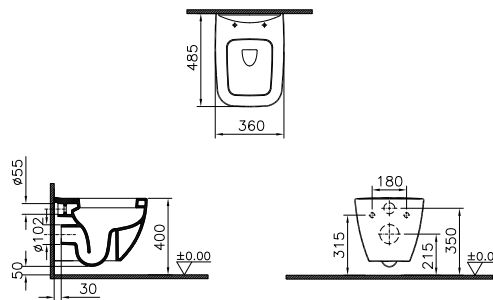

Product description	Code	W x H (mm)
Wall-hung WC pan, 48 cm, compact	4379B003-0090	360 x 485



D-Light Rim-ex close-coupled WC pan, back-to-wall







Product description	Code	W x H (mm)
Rim-ex close-coupled WC pan, back-to-wall, 70 cm (Universal outlet)	5913B003-0610	345 x 700

S50 Rim-ex close-coupled WC pan, back-to-wall









Product description	Code	W x H (mm)
Rim-ex close-coupled WC pan, back-to-wall, 65 cm (Universal outlet)	5746B003-0610	355 x 855

D-Light close-coupled WC pan, back-to-wall

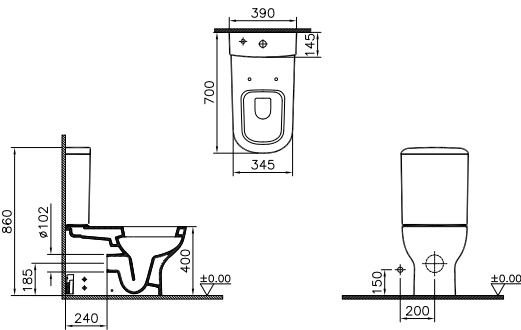







Product description	Code	W x H (mm)
Close-coupled WC pan, back-to-wall, 70 cm	5912B003-0610	345 x 700

S50 close-coupled WC pan, back-to-wall

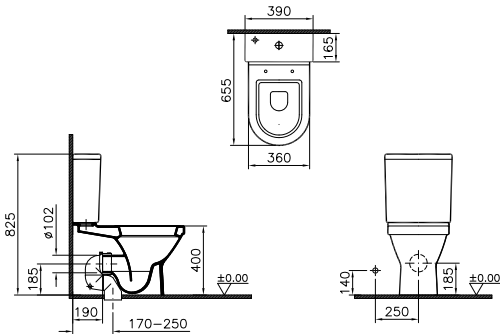





Product description	Code	W x H (mm)
Close-coupled WC pan, back-to-wall, 65 cm (Universal outlet)	5332L003-0610	350 x 855

S50 Rim-ex wall-hung WC pan

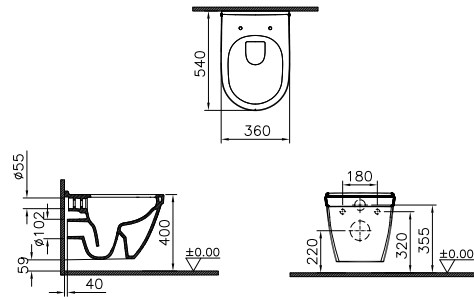

Additional pipe may be required as to wall thickness.

Product description	Code	W x H (mm)
Rim-ex wall-hung WC pan, 54 cm (Without side holes)	5956B003-0090	360 x 540



S50 Single WC pan, back-to-wall

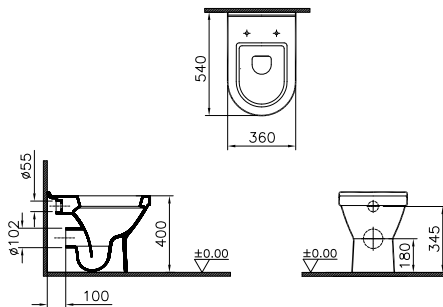

Product description	Code	W x H (mm)
Single WC pan, back-to-wall, 54 cm (Horizontal outlet)	5323L003-0090	360 x 540



S50 wall-hung WC pan

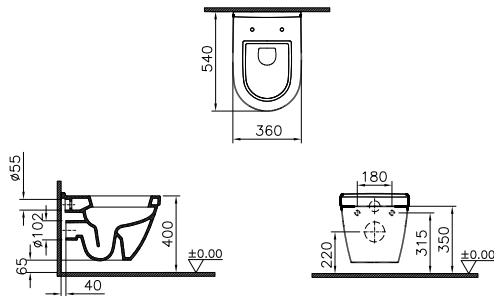

Additional pipe may be required as to wall thickness.

Product description	Code	W x H (mm)
Wall-hung WC pan, 54 cm (Without side holes)	5955B003-0090	360 x 540

S50 Single WC pan, back-to-wall

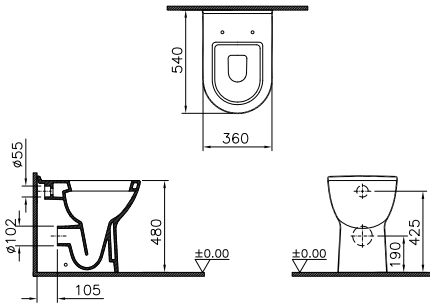

Product description	Code	W x H (mm)
Single WC pan, back-to-wall, 54 cm, high (Horizontal outlet)	5369L003-0090	360 x 540



S50 close-coupled WC pan, back-to-wall

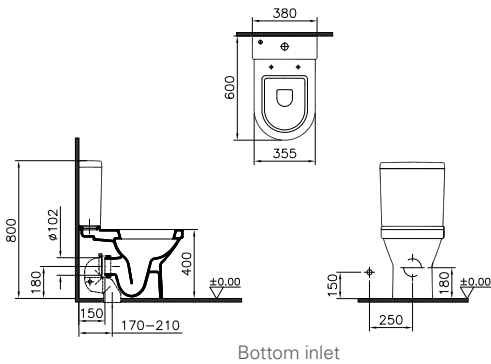

Product description	Code	W x H (mm)
Close-coupled WC pan, back-to-wall, 60 cm (Universal outlet)	5427L003-0610	380 x 600



Zentrum close-coupled WC pan, back-to-wall

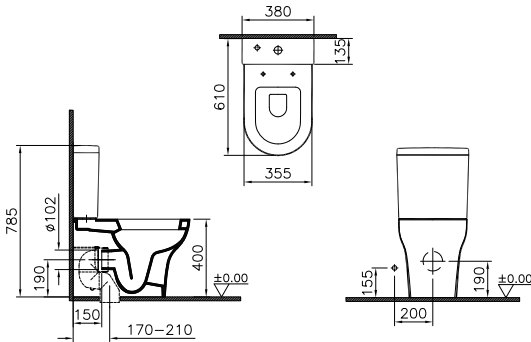

Product description	Code	W x H (mm)
Close-coupled WC pan, back-to-wall, 60 cm (Universal outlet)	5780L003-0610	380 x 610



Retro Rim-ex wall-hung WC pan

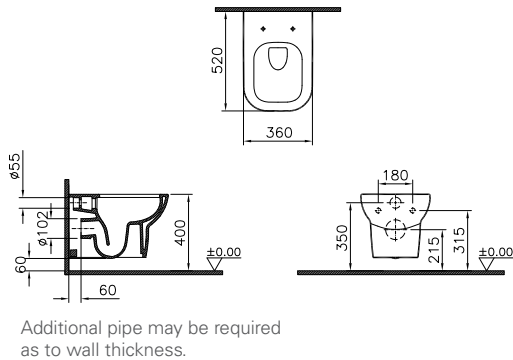

Product description	Code	W x H (mm)
Rim-ex wall-hung WC pan, 52 cm	7744B003-0850	360 x 520



Zentrum single WC pan, back-to-wall

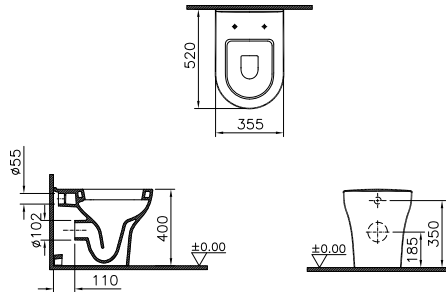

Product description	Code	W x H (mm)
Single WC pan, back-to-wall, 52 cm (Horizontal outlet)	5788L003-0090	355 x 520



S20 single WC pan, back-to-wall

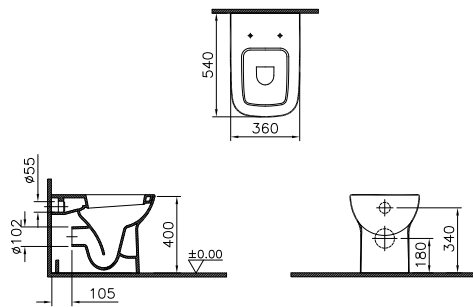

Product description	Code	W x H (mm)
Single WC pan, back-to-wall	5520L003-0090	360 x 540



RIM-EX
WC pan

The WC pan that beats all formulas for easy cleaning!

Arkitekt Rim-ex wall-hung WC pan

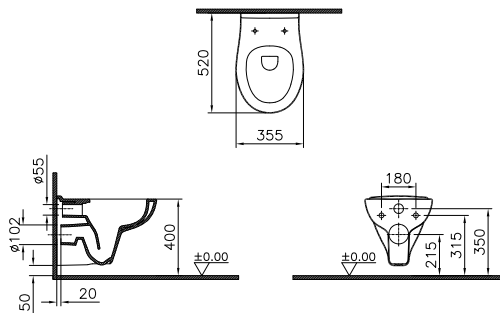

Product description	Code	W x H (mm)
Rim-ex wall-hung WC pan, 52 cm	7741B003-0850	355 x 520



RIM-EX ELIMINATES THE WC PAN RIM.

The rimless WC pan Rim-ex prevents proliferation thanks to its innovative design. Rim-ex is easy to clean, and offers maximum hygiene.

- Easy cleaning with one wipe
- 95% more hygienic*
- No rim or hole where dirt or harmful organisms could collect

Rim-ex WC pans are available in various models suitable for all bathroom styles.

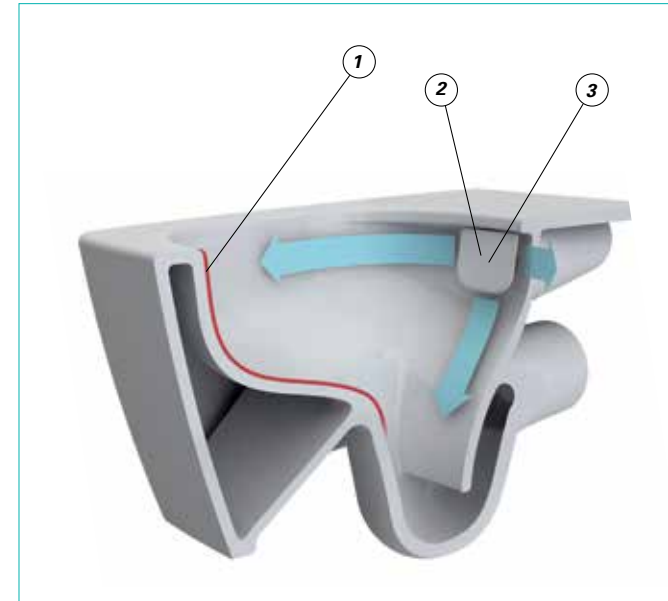

1. Rimless bowl

- Easy to clean surface without channel.
- No rim or hole where dirt or harmful organisms could collect.
- Bowl shape designed for efficient flushing.

2. Water outlet

- No rim where harmful organisms could proliferate.

3. Ceramic water diverter

- Removable ceramic part for easy cleaning.
- Optimal water distribution for efficient flush.



Standard WC pan

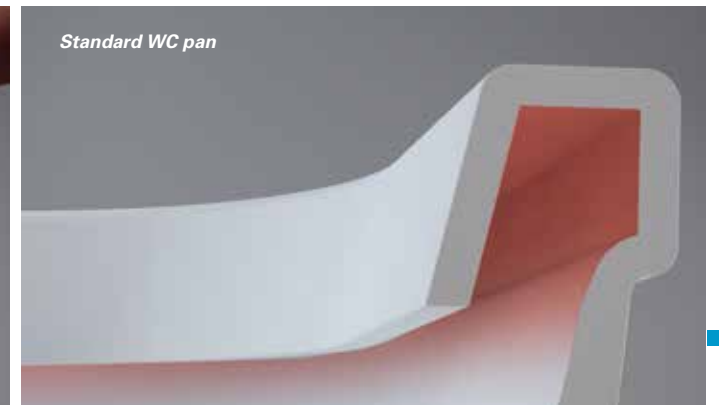

Standard WC pan



Rim-ex WC pan



Rim-ex WC pan

**Clearly superior: Tests undertaken by the Akdeniz University show Rim-ex is easier to clean and 95% more hygienic as compared to standard WC pans.*

Different solutions for various needs...

With WCs having bidet function, Vitra offers different solutions for different needs. Solutions involving universal bidet pipe enable both standard and concealed bidet connection applications optionally. Again, depending on the choice, it offers solutions developed with stop valve or concealed stop valve.

PRODUCTS WITH UNIVERSAL STOP VALVE CONNECTION

- » SUNRISE
- » RETRO
- » D-LIGHT
- » S50
- » ZENTRUM
- » S20
- » FORM 500
- » EURA
- » NORMUS
- » ARKITEKT



Sunrise wall-hung WC pan

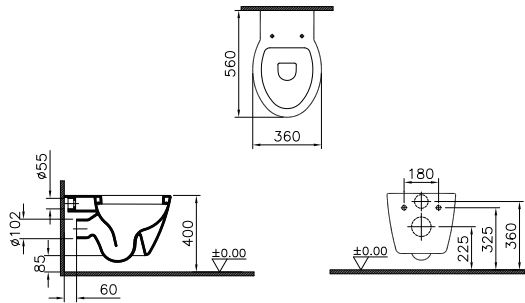

Additional pipe may be required as to wall thickness.

Product description	Code	W x H (mm)
Wall-hung WC pan, 56 cm	5384B003-0850	360 x 560



D-Light wall-hung WC pan

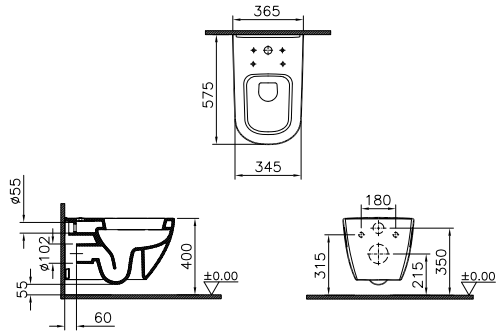

Additional pipe may be required as to wall thickness.

Product description	Code	W x H (mm)
Wall-hung WC pan, 57 cm	5910B003-0850	345 x 575



Retro wall-hung WC pan

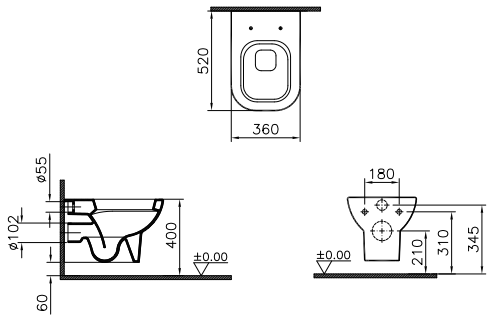

Product description	Code	W x H (mm)
Wall-hung WC pan, 52 cm	5160B003-0850	360 x 520



D-Light Rim-ex wall-hung WC pan

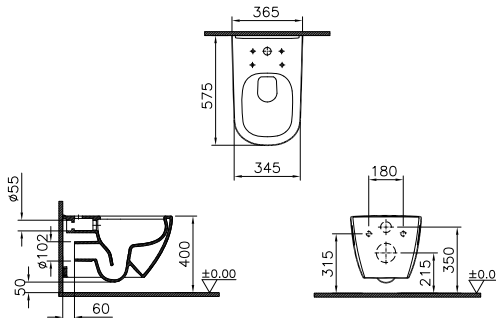

Additional pipe may be required as to wall thickness.

Product description	Code	W x H (mm)
Rim-ex wall-hung WC pan, 57 cm	5911B003-0850	345 x 575



S50 Rim-ex wall-hung WC pan

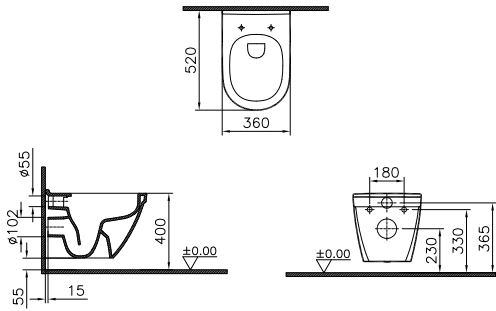

Product description	Code	W x H (mm)
Rim-ex wall-hung WC pan, 52 cm	7740B003-0850	380 x 520



S50 wall-hung WC pan, compact

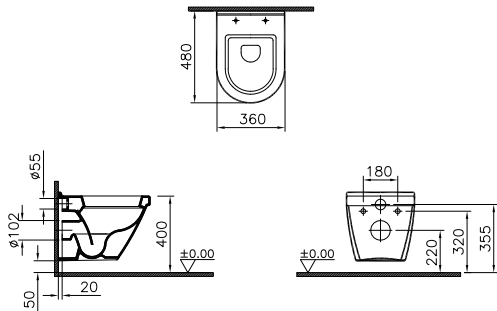

Product description	Code	W x H (mm)
Wall-hung WC pan, 48 cm, compact	5320L003-0850	380 x 480

S50 wall-hung WC pan

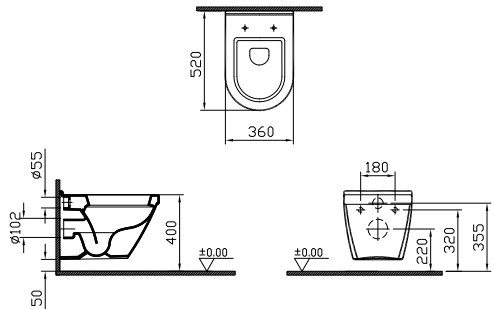

Product description	Code	W x H (mm)
Wall-hung WC pan, 52 cm	5318L003-0850	360 x 520

Zentrum Rim-ex wall-hung WC pan

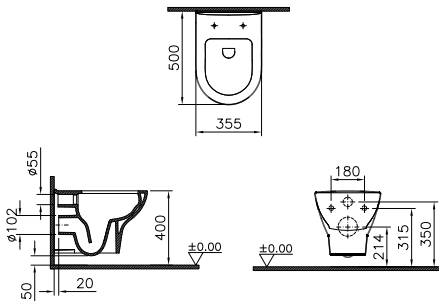

Product description	Code	W x H (mm)
Rim-ex wall-hung WC pan, 50 cm	5795B003-0850	355 x 500



Zentrum wall-hung WC pan

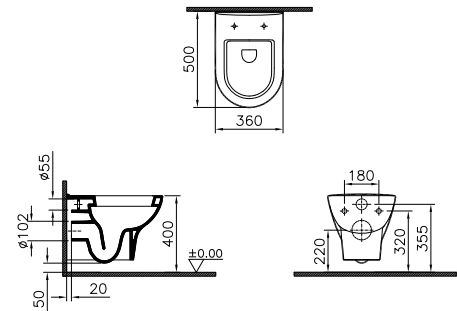

Product description	Code	W x H (mm)
Wall-hung WC pan, 50 cm	5785L003-0850	360 x 500



S20 wall-hung WC pan

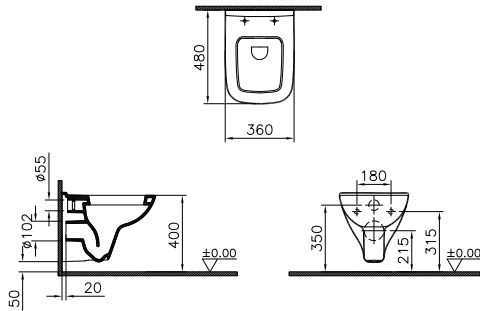

Product description	Code	W x H (mm)
Wall-hung WC pan, 48 cm	5505L003-0868	360 x 480



S20 wall-hung WC pan

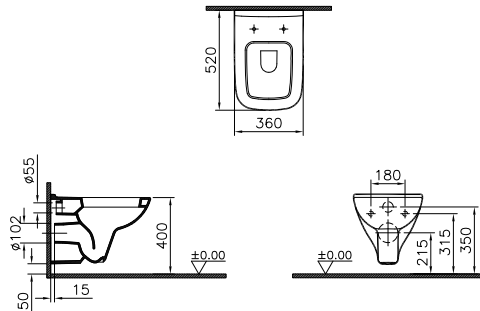

Product description	Code	W x H (mm)
Wall-hung WC pan, 52 cm	5507L003-0868	380 x 520



Eura wall-hung WC pan

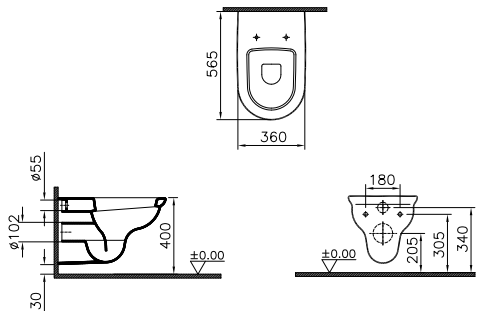

Product description	Code	W x H (mm)
Wall-hung WC pan, 56 cm	6270L003-0850	380 x 585



Normus wall-hung WC pan

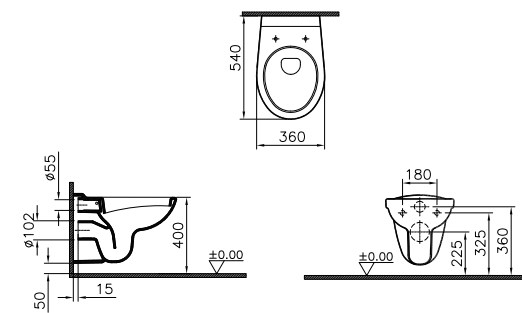

Product description	Code	W x H (mm)
Wall-hung WC pan, 54 cm	6855L003-0868	360 x 540

Arkitekt wall-hung WC pan, compact

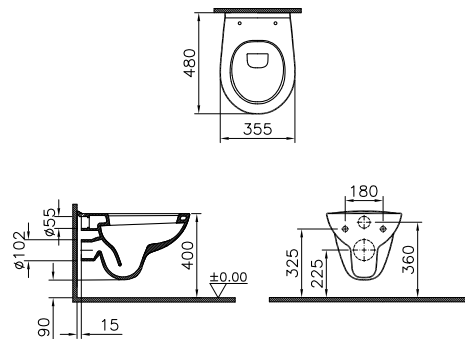

Product description	Code	W x H (mm)
Wall-hung WC pan, 48 cm, compact	6105L003-0850	355 x 480

Arkitekt wall-hung WC pan

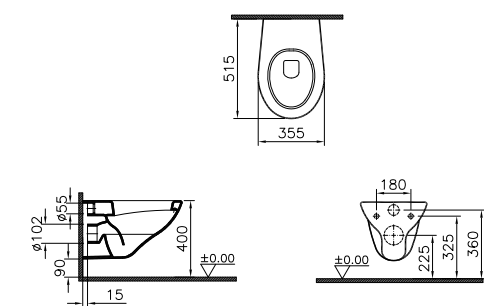

Product description	Code	W x H (mm)
Wall-hung WC pan, 52 cm	6107L003-0850	355 x 515

Experience intimate hygiene with water

Solutions with standard water connection an application where the stop valve connection is visible and the flexible hose enters from the hole on the lateral side of the WC.

PRODUCTS WITH STANDARD BIDET CONNECTION

- » ARIA
- » RETRO
- » D-LIGHT
- » S50
- » ZENTRUM
- » S20
- » ARKITEKT



Aria close-coupled WC pan, open back

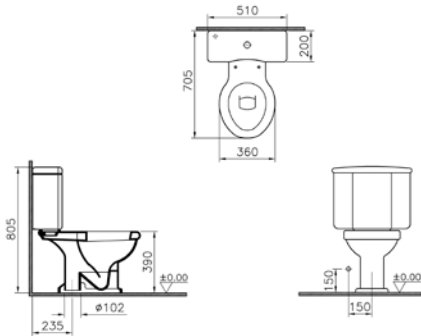

Product description	Code	W x H (mm)
Close-coupled WC pan, open back, 70 cm (Vertical outlet)	6275B003-0088	510 x 705

Aria single WC pan, open back

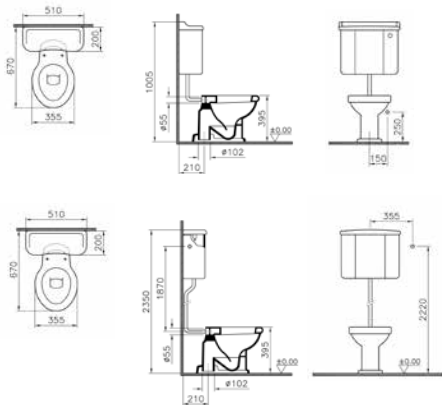

Product description	Code	W x H (mm)
Single WC pan, open back, 67 cm (Vertical outlet)	4270B003-0088	510 x 670

Aria close-coupled WC pan, open back

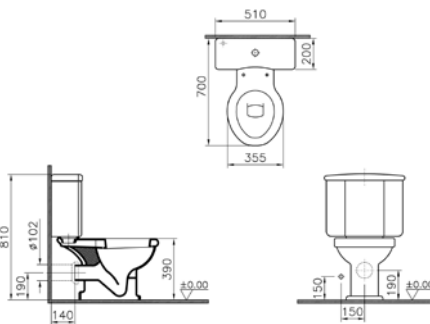

Product description	Code	W x H (mm)
Close-coupled WC pan, open back, 70 cm (Horizontal outlet)	6285B003-0088	510 x 700

Aria single WC pan, open back

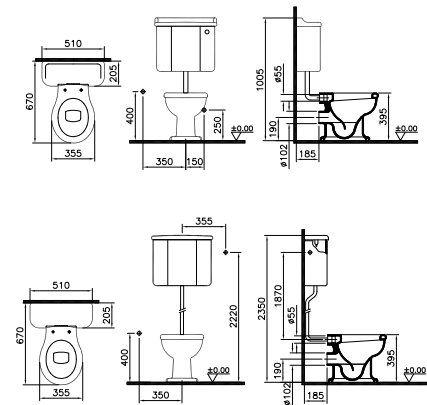

Product description	Code	W x H (mm)
Single WC pan, open back	6233B003-0088	355 x 870

D-Light close-coupled WC pan, back-to-wall



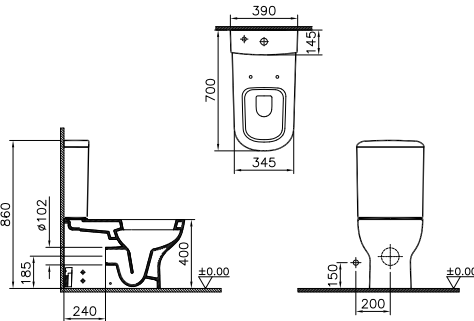





Product description	Code	W x H (mm)
Close-coupled WC pan, back-to-wall, 70 cm (Universal outlet)	5912B003-0092	390 x 700

D-Light close-coupled WC pan, open back

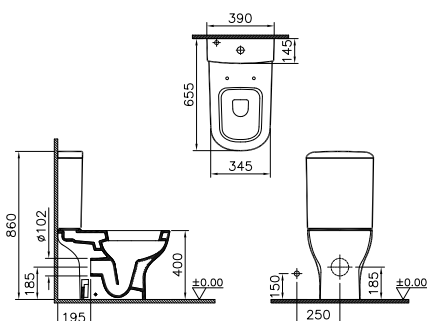







Product description	Code	W x H (mm)
Close-coupled WC pan, open back, 65 cm (Universal outlet)	5914B003-0096	390 x 655

D-Light Rim-ex close-coupled WC pan, back-to-wall

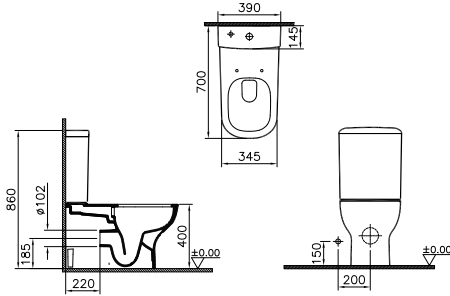





Product description	Code	W x H (mm)
Rim-ex close-coupled WC pan, back-to-wall, 70 cm (Universal outlet)	5913B003-0092	390 x 700

D-Light Rim-ex close-coupled WC pan, open back







Product description	Code	W x H (mm)
Rim-ex close-coupled WC pan, open back, 65 cm (Universal outlet)	5915B003-0096	390 x 650

S50 Rim-ex close-coupled WC pan, open back



Product description	Code	W x H (mm)
Rim-ex close-coupled WC pan, open back, 65 cm (Universal outlet)	5745B003-0088	390 x 655



S50 close-coupled WC pan, open back

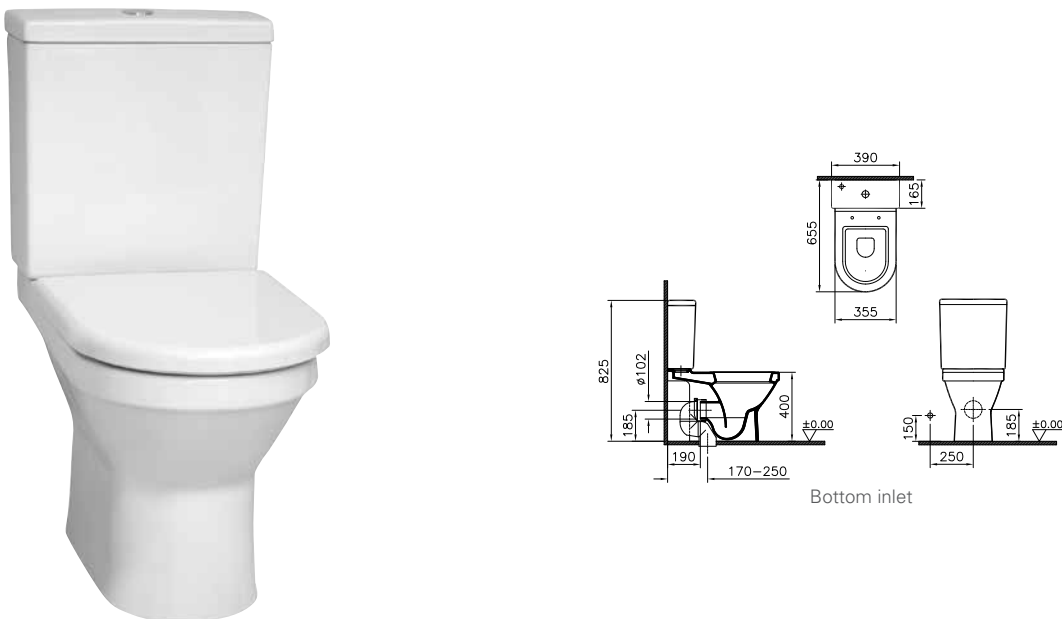

Product description	Code	W x H (mm)
Close-coupled WC pan, open back, 65 cm (Universal outlet)	5321L003-0088	390 x 655



S50 Rim-ex close-coupled WC pan, back-to-wall

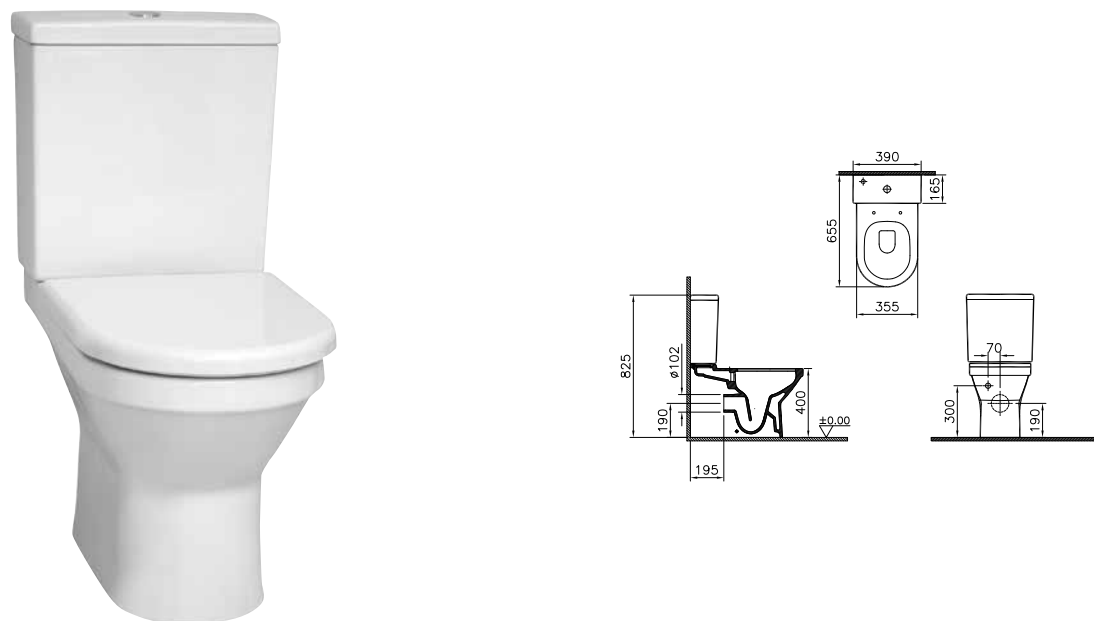

Product description	Code	W x H (mm)
Rim-ex close-coupled WC pan, back-to-wall, 65 cm (Universal outlet)	5746B003-0092	390 x 655



S50 close-coupled WC pan, back-to-wall

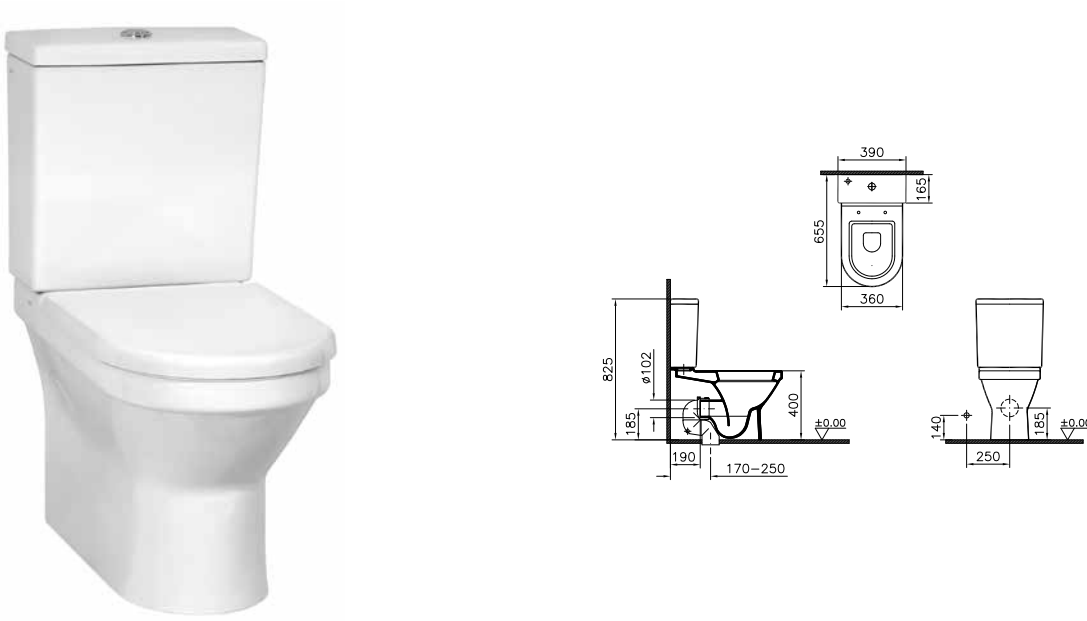

Product description	Code	W x H (mm)
Close-coupled WC pan, back-to-wall, 65 cm (Universal outlet)	5332L003-0092	390 x 655



S50 close-coupled WC pan, open back, high

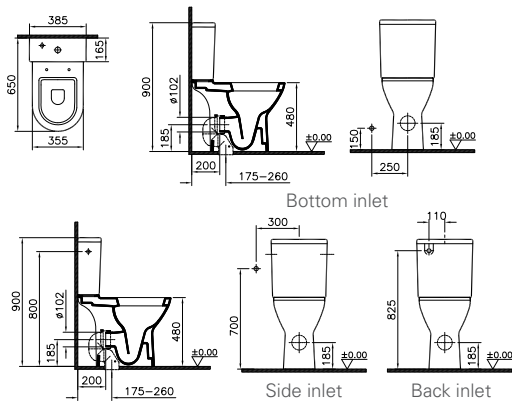

Product description	Code	W x H (mm)
Close-coupled WC pan, open back, 65 cm, high (Universal outlet)	5421B003-0088	385 x 650



S50 single WC pan, back-to-wall

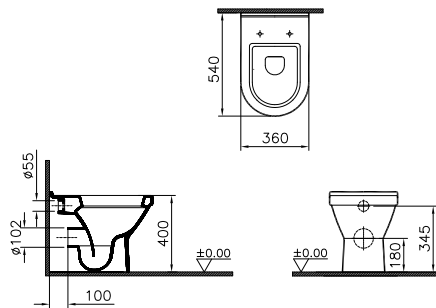

Product description	Code	W x H (mm)
Single WC pan, back-to-wall, 54 cm (Horizontal outlet)	5323L003-0088	350 x 540



S50 close-coupled WC pan, back-to-wall

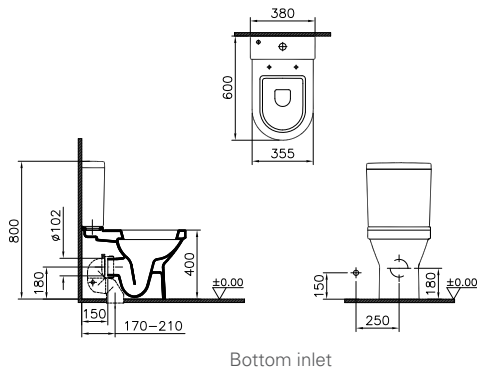

Product description	Code	W x H (mm)
Close-coupled WC pan, back-to-wall, 60 cm (Universal outlet)	5427L003-0092	380 x 600



S50 single WC pan, open back

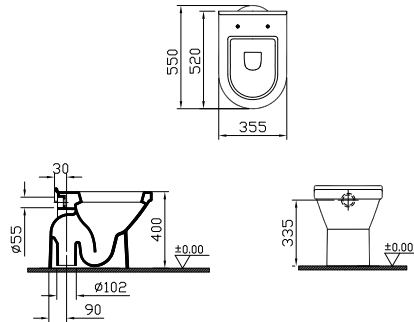

Product description	Code	W x H (mm)
Single WC pan, open back, 55 cm (Vertical outlet)	5304L003-0088	550 x 355

S50 single WC pan, back-to-wall, high

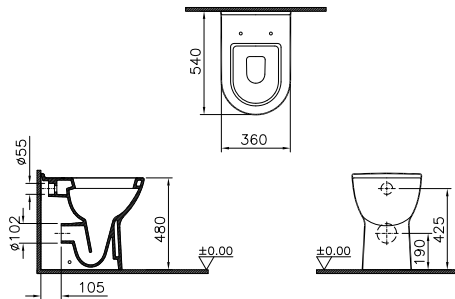

Product description	Code	W x H (mm)
Single WC pan, back-to-wall, 54 cm, high (Horizontal outlet)	5369L003-0088	360 x 540

Zentrum single WC pan, back-to-wall

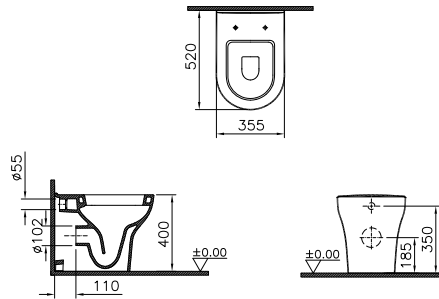

Product description	Code	W x H (mm)
Single WC pan, back-to-wall, 52 cm (Horizontal outlet)	5788L003-0088	355 x 520



S50 close-coupled WC pan, back-to-wall

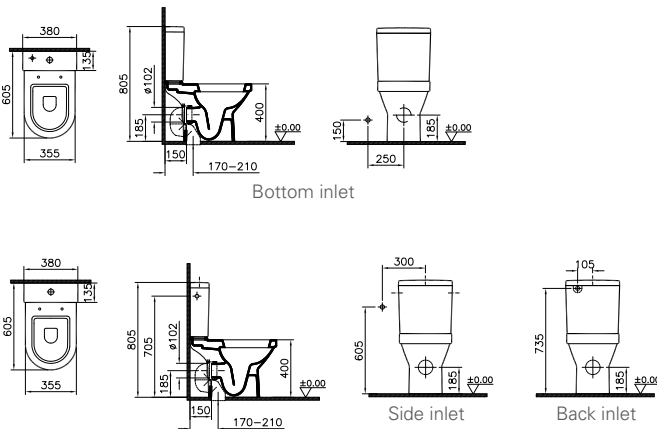

Product description	Code	W x H (mm)
Close-coupled WC pan, back-to-wall, 60 cm (Universal outlet)	5424L003-0088	380 x 605



Zentrum close-coupled WC pan, back-to-wall

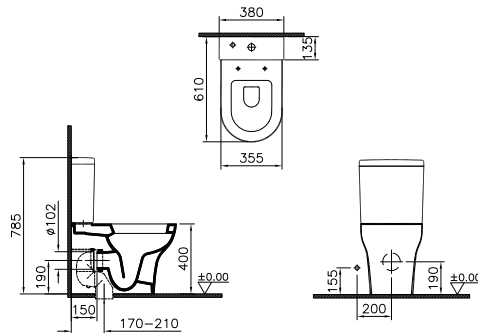

Product description	Code	W x H (mm)
Close-coupled WC pan, back-to-wall, 60 cm (Universal outlet)	5780L003-0092	380 x 610



S20 close-coupled WC pan, open back

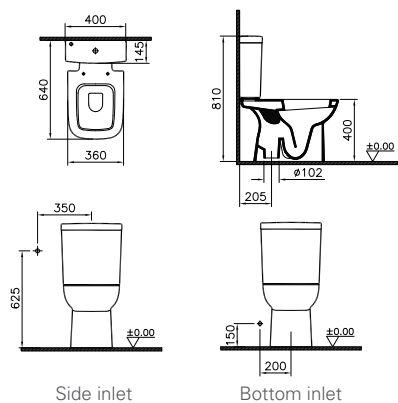

Product description	Code	W x H (mm)
Close-coupled WC pan, open back, 64 cm (Vertical outlet)	5510L003-0088	400 x 640



S20 close-coupled WC pan, open back

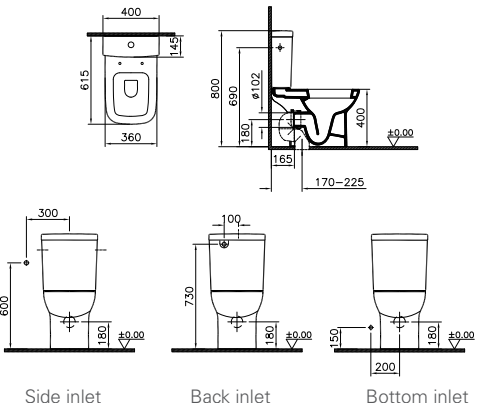

Product description	Code	W x H (mm)
Close-coupled WC pan, open back, 62 cm (Universal outlet)	5513L003-0088	400 x 615



S20 close-coupled WC pan, back-to-wall

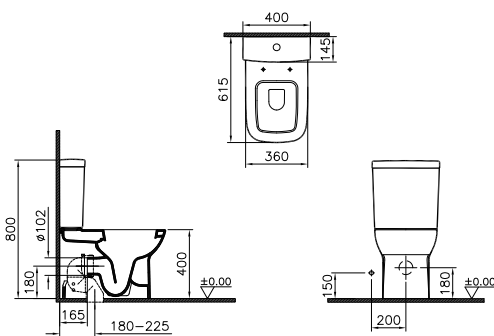

Product description	Code	W x H (mm)
Close-coupled WC pan, back-to-wall, 62 cm (Universal outlet)	5512L003-0092	400 x 615



S20 close-coupled WC pan, open back

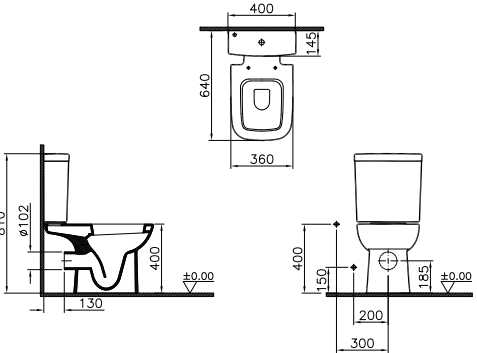

Product description	Code	W x H (mm)
Close-coupled WC pan, open back, 64 cm (Horizontal outlet)	5511L003-0088	400 x 640



S20 single WC pan, back-to-wall

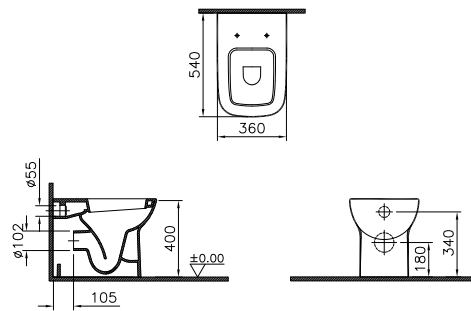

Product description	Code	W x H (mm)
Single WC pan, back-to-wall, 54 cm (Horizontal outlet)	5520L003-0088	360 x 540



USE OF WC WITH BIDET FUNCTION

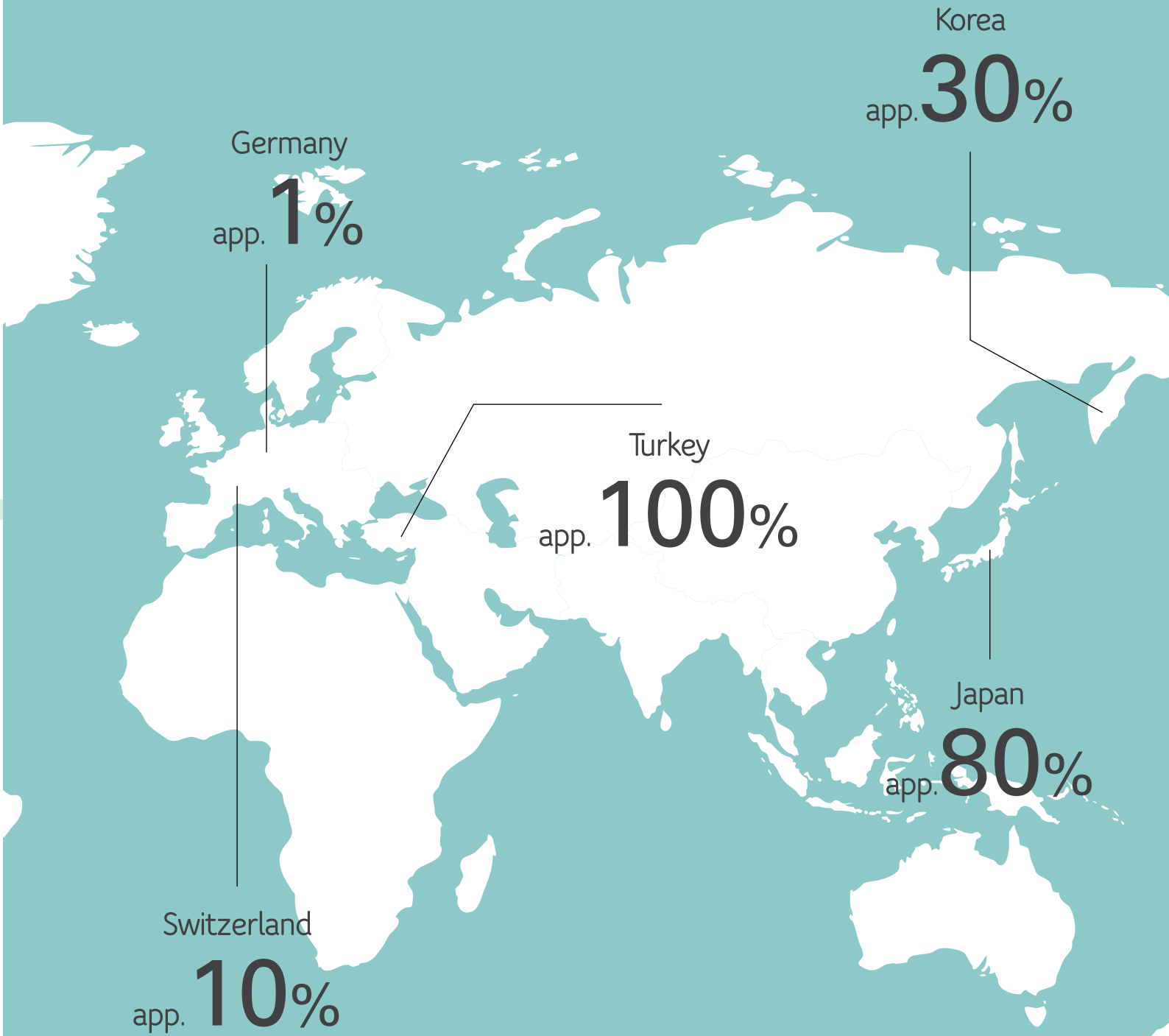

Arkitekt close-coupled WC pan, back-to-wall

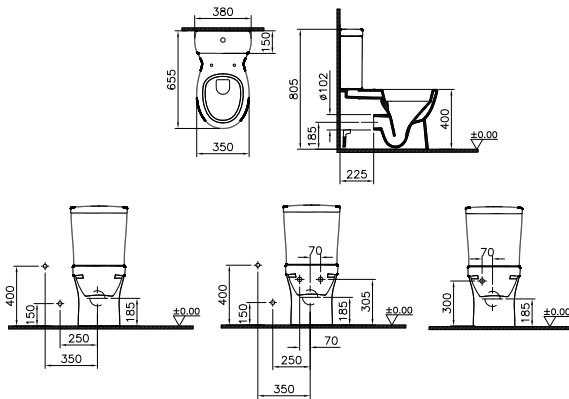

Product description	Code	W x H (mm)
Close-coupled WC pan, back-to-wall, 65 cm (Universal outlet)	5930L003-1512	350 x 655



BIDET NOZZLES

4 DIFFERENT BIDET NOZZLE OPTIONS

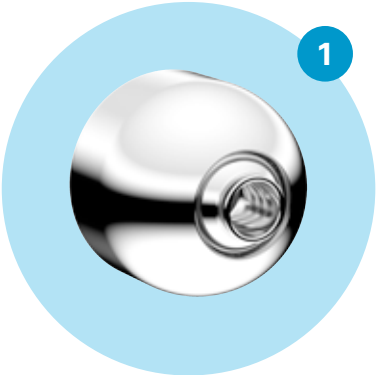

20x15 mm chrome coated plastic bidet nozzle

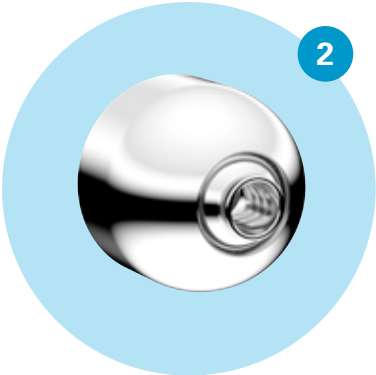

20x15 mm chrome coated brass bidet nozzle

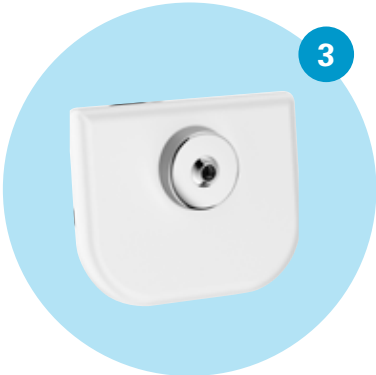

Bidet nozzle for Rim-ex WC Pan

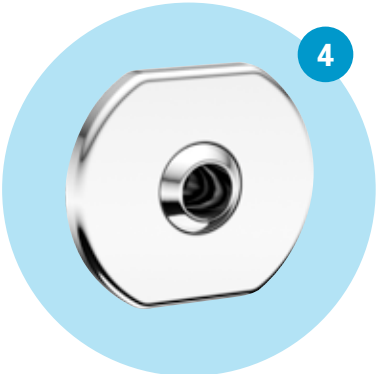

Chrome coated brass zero bidet nozzle

Each Different WC Pan has different bidet nozzle option, you can find the detailed list at 72-73 pages.

Compitable Bidet Nozzles for WC Pans

Code	120x15 mm chrome coated plastic bidet nozzle	220x15 mm chrome coated brass bidet nozzle	3Bidet nozzle for Rim-ex WC Pan	4Chrome coated brass zero bidet nozzle
2110	x			
2111	x			
2534	x			
2553	x			
4160	x			
4164	x			
4270		x		
4392		x		
4393		x		
4395		x		
4448				x
4449				x
4465				x
4470				x
5032		x		
5091	x			
5092	x			
5110	x			
5111	x			
5119		x		
5126	x			
5159		x		
5160		x		
5161	x	x		
5173		x		x
5176			x	
5216		x		
5247	x			
5248	x			
5283	x			
5293	x			
5318	x			x
5319	x			
5320	x			x
5321	x			
5323	x			
5332	x			
5369	x			
5384	x			x
5388	x			
5389		x		
5421	x			
5424	x			
5426	x			
5427	x			x
5505	x			
5506	x			
5507	x			
5512	x			x
5513	x			
5516	x			
5517	x			
5520	x			
5575	x			
5648				x
5671				x
5676				x

Code	120x15 mm chrome coated plastic bidet nozzle	220x15 mm chrome coated brass bidet nozzle	3Bidet nozzle for Rim-ex WC Pan	4Chrome coated brass zero bidet nozzle
5677				x
5745			x	
5746			x	
5754				x
5780	x			
5781	x			
5785	x			x
5788	x			
5789			x	
5795			x	
5811	x			
5812	x			
5813	x			
5814	x			
5815	x			
5816	x			
5817			x	
5818	x			
5820	x			
5821	x			
5822			x	
5871	x			
5885			x	
5910	x			x
5911			x	
5912	x			
5913			x	
5914	x			
5915			x	
5930	x			
5955				x
5956			x	
6047	x			
6105	x			x
6106	x			
6107	x			x
6233		x		
6270	x			
6553	x			
6623	x			
6855	x			
6858	x			
6860	x			
6875	x			
6888	x			
7672			x	
7740			x	
7741			x	
7742			x	
7743			x	
7744			x	
7747			x	
7748			x	
7749			x	
7755			x	
8110	x			
8111	x			



Blue Life

For our blue planet...

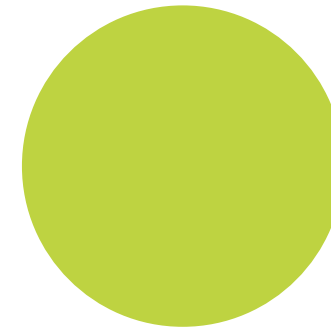

Blue Life is Vitra's dedicated approach to sustainable production, management and design.

Production

Our manufacturing plants make smart use of resources and invest in recycling systems that minimize raw material consumption and energy waste.

Through adjustments in kiln temperatures, we use 15 percent less energy in firing processes.

Our wastewater treatment system enables us to reuse all the effluent from our production processes and reduce freshwater consumption.

100 percent of the sludge from our ceramic sanitary ware plant is recycled as raw material for our tile production.

Management

Sustainability is a central component of our management practices involving employees, stakeholders and social projects. Vitra employees receive training on efficient water and energy use, and we expect our business partners to share our concern and take action as well.

Vitra is a longstanding sponsor of the Eczacıbaşı Hygiene Project, which strives to improve the quality of life at primary boarding schools through improvements in infrastructure, social programs and awareness of good personal hygiene practices.

Design

Sustainability principles guide our design process. Smartly designed Vitra products for residential and public spaces minimize end-user water consumption.

Our urinals, WC pans and faucets enable households to save as much as 190 tons of water per year.

Production Certificates
ISO 9001 Quality Management
ISO 14001 Environmental Management
EN 16001 Energy Management
OHSAS 18001 Occupational Health and Safety Management



Institut Bauen
und Umwelt e.V.

World's first
Environmental
Product Declaration
for ceramic sanitary
ware



Institut Bauen
und Umwelt e.V.

Turkey's first and
only Environmental
Product Declaration
for faucets



Turkey's first
European
Water Label for
faucets



Institut Bauen
und Umwelt e.V.

Turkey's first and
only Environmental
Product Declaration
for porcelain tiles



Turkey's first and
only European Eco-
label for porcelain
tiles



Turkey's first and
only Greenguard
Gold Certificate for
porcelain tiles

ICON GUIDE



Rim-ex
The innovative Rim-ex is easily cleaned thanks to its rimless bowl design, prevents germ proliferation and provides maximum hygiene. According to the tests carried out by Akdeniz University, VitrA Rim-ex WC pan which offers an integral and aesthetic appearance is 95% more hygienic in comparison to standard WC pans.



Water saving
Toilets which are developed by VitrA and approved as the least water consuming toilets with their water use of 2,5/4 L according to the European Union norms, use less water thanks to their special bowl structure and flush valves. Up to 70% water-saving is achieved when VitrA concealed tanks are used together with special bowl WC pans.



Green building certification
The products which contribute, with their various environmental properties, to the projects in which the green building certifications (LEED, BREEAM and DGNB) are applicable. These products which have a less environmental footprint are recommended to be included in projects in terms of their water-saving characteristics, completed life cycle analyses (LCA), environmental product declarations (EPD), the local materials used, etc.



VitrAclean
Water stains and lime residues are an important problem for bathrooms. With VitrAclean technology, washbasins, WC pans, urinals and bidets are coated through special double glazing method which is water-resistant. Therefore, the sanitaryware can be kept stain-free and nice for years without need for strong chemicals used as detergents.



VitrAhygiene
It provides reliable environment in water closets and bathrooms which are the most risky places in terms of cleaning. From washbasins to WC pans, urinals to bidets; the products manufactured with special glaze thanks to VitrA technology maintain their first day performance and provide extra hygiene during the period they are used.



Easy installation
Easy and rapid installation with innovative practices



Special Needs
VitrA bathroom products designed for meeting the needs of the old and disabled people are convenient for use with wheelchair while providing easiness in the bathroom.



Soft-close
Special hinge ensures silent and soft closing.

STANDARDS

Load bearing capacity of the washbasins:
100 kg for 1 hour.
(EN 14688)

Load bearing capacity of the WC pans:
400 kg for 1 hour.
(EN 997)

WC seats should tolerate:
30 thousand turn on-turn off operations
15 thousand turn on-turn off operations
(Products not approved by NF)
(NF D 12-207)

WARRANTY PERIODS

10 Years
Ceramic Sanitaryware (Ceramic Parts)
3,5mm Steel tubs
Acrylic Surface
Acrylic Bathtub Bodies
Acrylic Panels

7 Years
Faucets (Manually controlled faucet)
Diverter, Spouts
Taps
Built-in Stop Valves

5 Years
VitrA Pro concealed cisterns
8 and 12cm concealed cisterns
Cistern Mechanism(Plastic Parts)
Mechanical & Pneumatic Control Panels
Shower Systems
Bathroom Accessories
Waste Sets

2 Years
Whirlpools
Spa Systems
Waste Outlets
Compact Systems
Massage Shower Systems
2,2 stell tubs
V-care Intelligent WC
Drain Systems
Seat Covers
Photocell Controlled concealed cistern sets
Photocell Controlled control panels
Shower Systems
Special Need's Pack
Bathroom Furniture
Electronic Faucets

It should be also noted that any failure or defect resulting from inappropriate assembly and misuse is not covered by this warranty. Vitra will offer a free replacement or replacement parts (or the nearest equivalent) if the product fails due to manufacturing faults within the warranty period.

Head Office

Vitra Bathroom Group
Eczacıbaşı Yapı Gereçleri
San. ve Tic. A.Ş.
Ali Kaya Sok. No:7 K: 5
34394, Levent, İstanbul /Turkey
T: +90 212 350 80 00
F: +90 212 350 85 80
www.vitra.com.tr

Sales Offices

TURKEY
Intema A.Ş.
Ali Kaya Sok. No:7
34394, Levent, İstanbul / Turkey
T: +90 212 350 80 00
F: +90 212 350 85 80

CENTRAL EUROPE
Vitra-Bad GmbH
Agrippinawerft 24
50678 Köln / Germany
T: +49 221 277368-0
F: +49 221 277368 500
info@vitra-bad.de
www.vitra-bad.de
www.vitra-studio.de

FRANCE
VitroA c/o Burgbad S.A.S
Z.I. Le Poirier - CS 80019
F - 28132 Nogent Le Roi Cedex/France
T: +33 (0)1 39 97 88 19
F: +33 (0)2 37 51 43 94
info-contact@vitro-bad.fr

UK & IRELAND
Vitra UK Limited
Park 34, Collett
Didcot, Oxon
OX11 7WB
United Kingdom
Tel: +44 (0) 1235 750990
Fax: +44 (0) 1235 750980
www.vitra.co.uk

Vitra RUSSIA (EBP)
Miklukho-Maklaya Str., 36A
Room XXII, 5th Floor,
Trading Centre "MC"
Moscow 117279
Russian Federation
T: +7 (495) 640 44 14
F: +7 (495) 640 44 14 - 134
www.vitra-russia.ru

UAE
Jumeirah Business Centre 5 (JBC5)
Unit No: 1006 Plot No: W1
Jumeirah Lake Towers
Dubai / UAE
T: +971-4457 24 76
F: +971-4457 24 67

INDIA
B- 102, Durolite House, Opp. SAB TV
Building, New Link Road, Andheri (West),
Mumbai – 400 053
T: +91-22-6708 5000
F: +91-22-6127 6000
www.vitra-india.com

A - 288, Defense Colony, Ground Floor,
New Delhi – 110024
Phone: 011 40525900/40524800
www.vitra-india.com

Showrooms

Cologne Showroom
Vitra-Bad GmbH
Agrippinawerft 24
50678 Köln / Germany
T: +49 221 277368-0
F: +49 221 277368 500
info@vitra-bad.de
www.vitra-studio.de
www.vitra-bad.de

Moscow Taganskaya Showroom
Taganskaya Street 31/22
109147 Moscow
T: +7 (495) 221 76 10

NOTES

NOTES